

Aquila 54 Yacht Power Catamaran Specifications

Length overall w/swim platform (exc. anchor roller)	16.5 M / 54' 2"
Beam overall	7.68 M / 25' 2"
Height above waterline w/ hard top (excluding electrics and electronics)	6.15 M / 20' 2"
Height above waterline w/ hard top (including light and radar mast)	7.43 M / 24' 4"
Draft including propellor (approximate - will vary depending on load)	1.37 M / 4' 6"
Light displacement with D6 Volvo Penta	23,300 KG / 52,367 LB
Fully loaded displacement with D8 Volvo Penta	30,000 KG / 66,138 LB

Tankage

Fuel tank (standard)	2,200 L / 581 GAL
Fuel tank (reserve)	720 L / 190 GAL
Water tank (standard)	1,000 L / 238 GAL
Holding tank (total)	340 L / 90 GAL

CE certification *(internationally recognized)*

Cat. A (Ocean)	12 PAX
Cat. B (Offshore)	12 PAX
Cat. C (Coastal)	20 PAX
Cat. D (Inland/Sheltered)	30 PAX

Accommodation

Cabins	3 / 4 / 5
Heads with separate showers	3 / 4 / 5
Sleeps up to	10+
Maximum Passengers	30

Propulsion

Standard	2x D6 380 HP VOLVO PENTA INBOARD DIESEL
Optional	2x D6 480 HP VOLVO PENTA INBOARD DIESEL
Optional	2x 550 HP CUMMINS QSB6.7 INBOARD DIESEL

All specifications and options are subject to change by Sino Eagle Yachts at their sole discretion. Performance is purely indicative and not a contractual commitment. Performance is subject to many variances outside the control of Sino Eagle Yachts. Specifications and graphics in this brochure are non-binding and customer must enter into contractual agreement with the Dealer or Agent of Record.

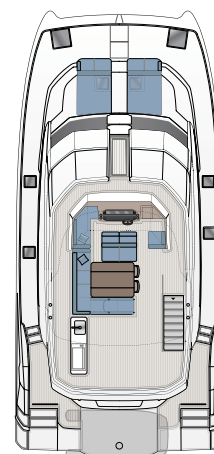

STANDARD
FLYBRIDGE

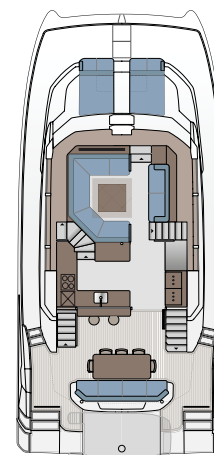

STANDARD
MAIN DECK

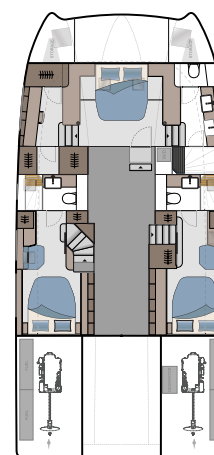

STANDARD
3-CABIN

Construction

Hull and deck material	InfusiCore vinyl ester resin infused throughout
Bulkhead and reinforcing	InfusiCore vinyl ester resin infused throughout
Core materials (vary in density)	PVC
Gel coat of hull	NPG
All main FRP components	Vinyl ester resin infused throughout
Bulbous Bows	Molded and attached; breakaway safety
Hull and deck windows	Tempered glass meeting ISO standards

Features

An exceptional performing and seaworthy hull shape providing first in class stability and comfort

Expansive outdoor living and entertaining spaces along with luxurious interior styling and amenities

Plenty of shade on flybridge via fiberglass hardtop with 316L polished stainless steel supports

Integrated bar area connecting social areas between aft cockpit and salon/galley

Comfortable seating throughout for up to thirty (30) people onboard

Direct bow access from central steps leading from flybridge to bow area

FUSION multi-zone audio system with Fusion speakers and Bluetooth connectivity

Premium comforts provided by way of three (3) cabins each with their individual walk in toilet with separate shower

Interior Layout

Full beam master suite including full size closet, master head with walk in shower and fresh water electric flush toilet

Guest cabins including full size head with walk in shower and fresh water electric flush toilet

Large salon area with ample comfortable seating

Large galley area with full size refrigerator/freezer and common household amenities

Hull and Deck Features

Six (6) opening deck hatches carefully positioned to enhance ventilation in cabins

Three (3) opening port hatches installed in hull side windows of heads

Custom built PVC rubrail with 316L stainless steel insert offering all around protection

Custom solid deck railings in 316L stainless steel

Two (2) comfortable and protected bow seats integrated into deck railing

Ten (10) Mooring cleats in solid 316L polished stainless steel thru bolted

Deck fill plates in 316L stainless steel: water (2); fuel (2); waste(3)

Stainless steel bow roller for secondary anchor

Anchor locker with 1700 watt windlass including handheld remote control with custom chain lock

Well placed ergonomic handrails in 316L stainless steel ensuring secure movement onboard

Forward access steps from flybridge to bow

Ergonomic transom steps for easy boarding and comfortable lounging off stern

Transom boarding rails in 316L stainless steel; located outboard of aft steps

High visibility LED navigation lights, running lights and anchoring light

Engine ventilation intakes with FRP cowling cover

Integrated manual retractable swim ladder in 316L stainless steel

Large starboard and port bow lockers with easy lift gas hinges for fender or gear storage; waterproof

Self draining storage locker in aft cockpit floor

Aft cockpit, flybridge and side decks all self draining

Aft cockpit bar area with two (2) stainless steel bar stools

Engine access lockers with easy lift gas hinge allowing easy access to engine room

Aft cockpit with expansive hinging window and door opening to galley

Aft cockpit seating area with dining table which comfortably seats ten (10)

Forward bow seating for relaxing and socializing

Integrated aft side boarding step in hull with 316L stainless steel handrail

Large spacious foredeck for sunbathing

LED downlighting in aft cockpit

Variable temperature stern shower located at port aft steps

Flybridge

Portugese style flybridge with walk around forward of windscreen

Exceptional flybridge access from two (2) stairway locations

Main access from aft cockpit

Handrails conveniently located all around flybridge for secure movement

Forward flybridge access via integrated steps

Forward fixed glass center windscreen with four (4) tempered glass panels

Windshield wiper with fresh water supply and variable speed control at helm

Electronic engine double lever throttle and gearshift control

Variable position stainless steel steering wheel

Hydraulic steering

Compass at helm station

Four (4) marine waterproof 6" 200w speakers located in hardtop

Spacious and comfortable helm seat for two (2) people with upholstered seat and backrest

Comfortable forward facing seats port and starboard adjacent of helm station

Flybridge table with fold down extensions comfortably seating nine (9) people

Upholstered flybridge cushions and backrests

Wet bar located aft deck area incorporating Corian work surface, sink with hot and cold faucet

Large storage area under wet bar with two (2) access doors (optional location for fridge and ice maker)

Dedicated life raft storage locker at transom area with easy launch

Lifejacket and safety gear storage under aft cockpit seats

Fourteen (14) cup holders located in various areas around flybridge

Engine Room

Engine exhaust to reduce engine emission noise
Automatic fire suppression heat activated system with alarm monitors at helm station
Engine room insulation (50mm) flame retardant polyurethane foam covered with metalized polyester film
316L stainless steel engine supports
Engine room lighting
Automatic electric bilge pump in each engine room
Excellent all around engine and systems access for ease of maintenance
Two (2) hydraulic steering cylinders with Optimus EPS power steering pumps

Engine Control

Electronic engine double lever throttle and gearshift control
Volvo Electronic Vessel Control (EVC) 4" display at helm station
Electronic start/stop switches at helm station with E-Key protection

Underwater Gear

Engine V-drive transmission for compact efficiency
Propeller tunnels for reduced draft and maximum efficiency
Four (4) blade bronze propellers
Propeller shaft – machined stainless steel
Rudders and tiller arm in 316L stainless steel with FRP tube
Shut off valves on all salt water intakes in engine rooms
Sea water strainers
Watertight self aligning dripless shaft seal with 316 stainless steel housing and self aligning teflon bearing
Extended bronze P-bracket for maximum propeller protection
Sacrificial keel forward of drive train for added running gear protection

Technical Features

Bilge pump warning lights
Instrument panels
Steering, tilt wheel
Steering wheel, stainless steel

Salon Area

Excellent all around visibility from salon seating
Shatter-proof windows with external overhangs offering excellent visibility and reduced direct sunlight
Tempered glass hinged window via tempered glass door to cockpit offers excellent ventilation and through flow
Laminate finishes with solid wood trim
Blinds covering port and starboard side windows
Overhead LED ceiling lights, LED mood lighting and LED courtesy lighting
Wall mounted LED lights
Panel ceilings with decorative solid wood trim and LED accent lighting
Comfortable open couch seating to starboard
U-shaped salon lounge settee around salon table with seating up to eight (8) people
Salon table
Large shelves behind settees
Cushions in soft easy clean upholstery
Hidden slide out mini bar in partition (4 cabin version only)
Bluetooth stereo head unit with DVD player
Four (4) ceiling mounted speakers 7.7" 200w

Salon converts into two (2) comfortable single beds
Vertical 316L stainless steel handrail in salon and galley
Synthetic flooring offering maintenance free natural look

Galley Area

Three burner propane hob
Dedicated microwave storage location with outlet
Large double door fridge/freezer
Single stainless steel sink with Corian worktop cover and single lever variable temperature faucet
Central island with storage drawers underneath
Storage cupboards and drawers offering ample storage for all galley accessories
Durable stain resistant Corian countertop
Slide out garbage bin under sink
Overhead LED ceiling lights as well as mood lighting
LED courtesy floor lighting
Synthetic flooring offering maintenance free natural look

Stateroom Areas

Large windows throughout offering excellent views
Dedicated hanging lockers
Custom blinds fitted on cabin hull windows
Concealed shade blind and insect screen on opening deck hatch where installed
Overhead LED ceiling lighting and floor courtesy lighting
Overhead LED reading lights
Aft starboard stateroom offering full size bed
Ample storage lockers and/or drawers under beds
150mm/6" memory foam mattresses
Synthetic wear resistant flooring offering maintenance free natural wood look
Large master stateroom mattress (60"W x 80" L / 195 cm x 203 cm)
Aft guest cabin mattress sizes (61.5"W x 79.8" L / 156 cm x 202 cm)

Heads and Separate Shower Stalls

Quiet electric push button control fresh water flush toilets with large bowl
Opening deck hatch offering ample ventilation
Blinds over hull window
Stylish above countertop wash basins with single lever variable temperature faucet
Corian countertop surrounding wash basin
Vanity lockers with mirrors
Synthetic wear resistant flooring offering maintenance free natural wood look
Separate shower stall with seat and flexible shower faucet (except cabin 4 where shown)
Acrylic door separating shower from the rest of the bathroom (except cabin 4 where shown)
Automatic shower and sink drain via dedicated sealed sump box
Overhead LED lighting
LED nightlight above wash basin

Navigation Area

Ample navigation work surface for charts and books
 C-Zone digital switch panel with transfer switches for all electrical systems
 Dedicated service panel for optional generator, desalinator and inverter control panels
 Dedicated electronics display panel offering easy access and visibility to electronic systems including optional VHF radio
 Multizone entertainment system master unit offering multi three (3) zone control
 Light switch panel controlling all salon, galley and aft cockpit lighting
 Remote battery switches for all onboard batteries

Water and Bilge System

Fresh water pressure pumps with accumulator tank offering equal water pressure throughout
 Backup fresh water pump
 Two (2) hot water cylinders (80 L/21 gal) powered by engine heat exchanges and AC power
 Two (2) connected water tanks (500 L/ 132 gal)
 Water tank level gauges

Waste System

Grey water from showers and sinks collected in two (2) sealed sump box's with auto discharge overboard
 Black water holding tanks discharged via deck pump out or overboard with macerator pumps
 Black water tank level gauges

Electrical System

C-Zone digital switching system
 Master control panel for 12v and shore power service
 Remote battery master switches at panel
 Five (5) house batteries 200 amp/hour, AGM technology in dedicated battery locker
 Two (2) dedicated engine batteries 200 amp/hour, AGM technology
 Shore side electrical system
 AC power supplied by two (2) 50amp 125/250v shore power cables
 Galvanic isolator protector system

Fuel System

Diesel fuel system with Racor water separation filters
 Dedicated fuel tank for each engine
 Racor fuel filters for each engine
 Aluminum fuel tanks with safety shut off valves and level monitors

Safety

Automatic fire suppression heat activated system with alarm monitors
 Bulbous bows integrated into hulls with sacrificial nose cone
 Small safety bulkheads bonded in close to transom as a safety barrier
 Owners operating manual
 CE certification

OPTIONAL LAYOUTS

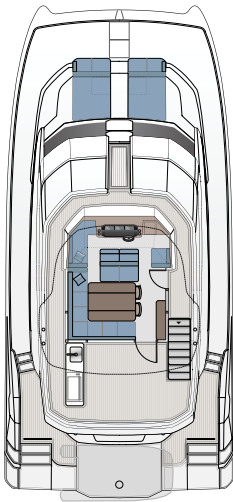

SKYLOUNGE FLYBRIDGE W/ NO
INTERIOR STAIRS & STANDARD SEATING

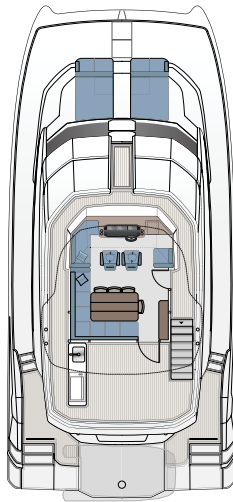

SKYLOUNGE FLYBRIDGE W/ NO INTERIOR
STAIRS & CAPTAIN CHAIRS

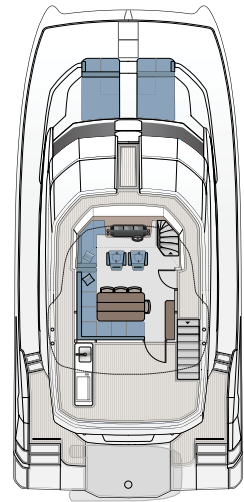

SKYLOUNGE FLYBRIDGE W/ INTERIOR
STAIRS & CAPTAIN CHAIRS

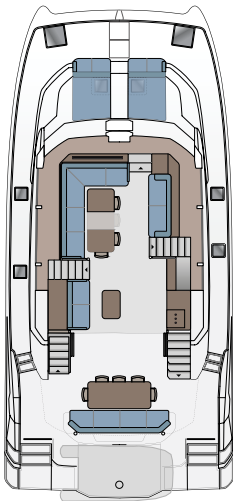

MAIN DECK W/GALLEY DOWN

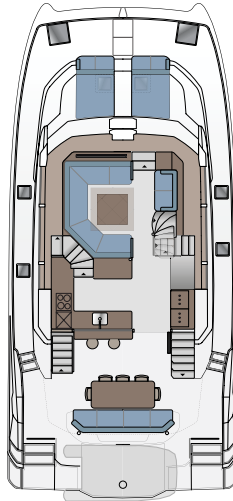

MAIN DECK W/INTERIOR
SKYLOUNGE FLYBRIDGE STAIRS
W/SKYLOUNGE

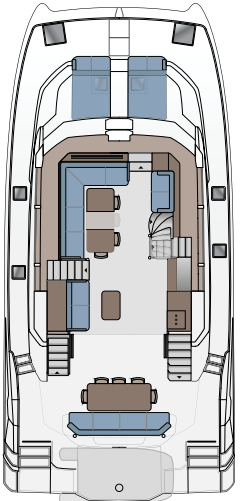

MAIN DECK W/GALLEY DOWN
INTERIOR SKYLOUNGE FLYBRIDGE STAIRS

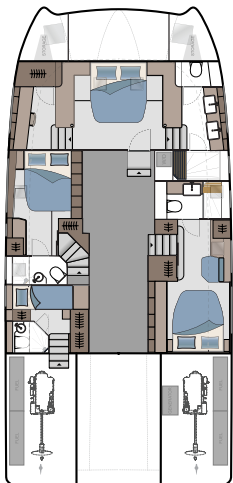

4-CABIN/4-HEAD

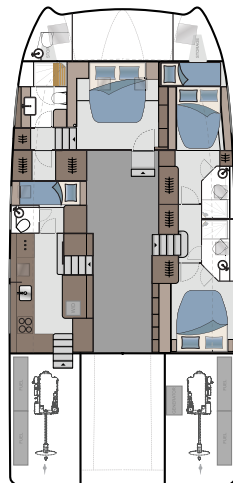

4-CABIN/4-HEAD
GALLEY DOWN

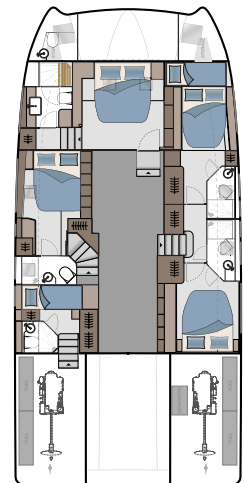

5-CABIN/5-HEAD



estupendanautica.com
info@estupendanautica.com
933 87 69 76



All specifications and options are subject to change by Sino Eagle Yachts at their sole discretion. Performance is purely indicative and not a contractual commitment. Performance is subject to many variances outside the control of Sino Eagle Yachts. Specifications and graphics in this brochure are non-binding and customer must enter into contractual agreement with the Dealer or Agent of Record.